

# TEENAGE MUTANT NINJA TURTLES®

## SHELL SUB

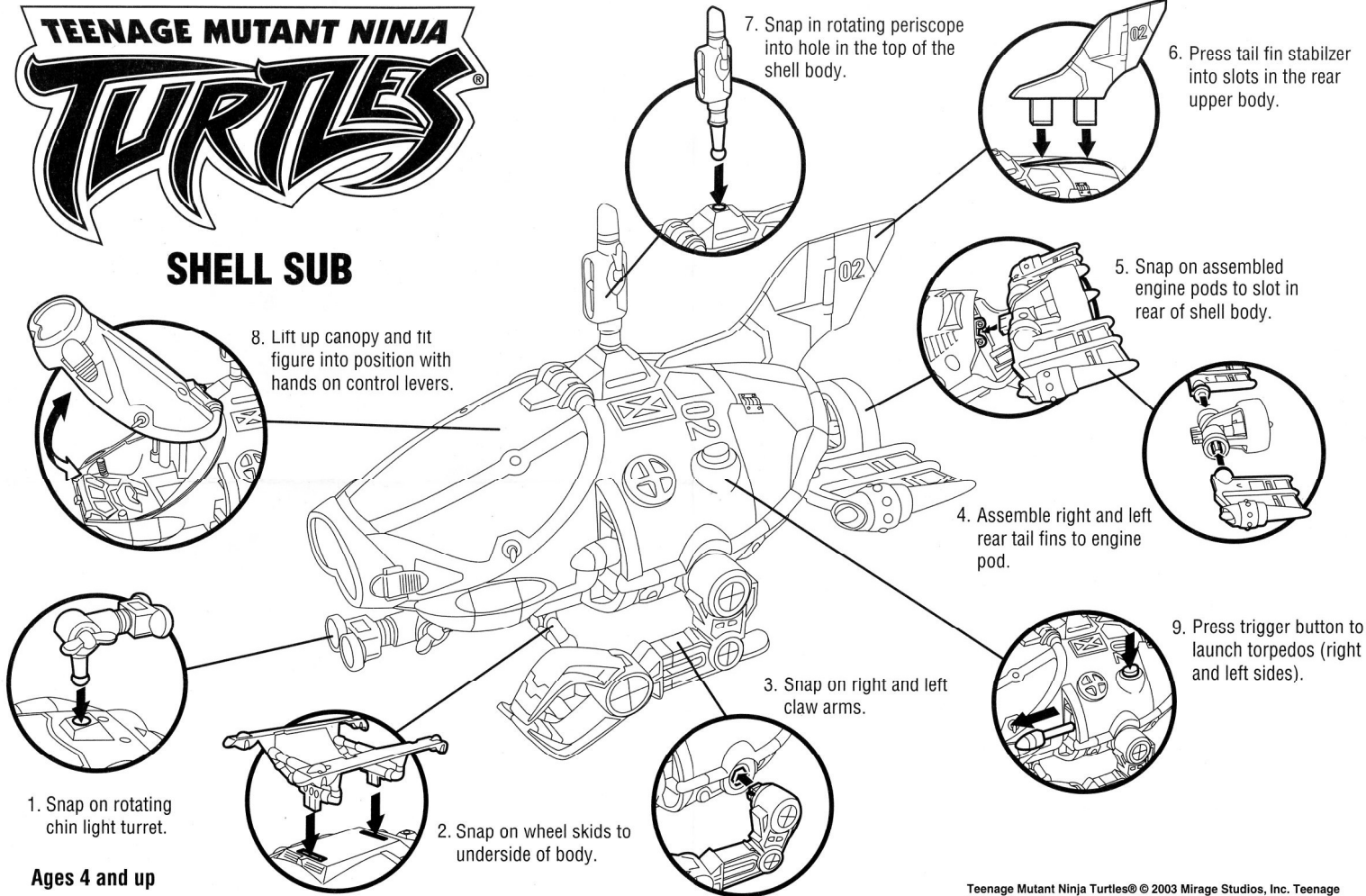

1. Snap on rotating chin light turret.

2. Snap on wheel skids to underside of body.

3. Snap on right and left claw arms.

4. Assemble right and left rear tail fins to engine pod.

5. Snap on assembled engine pods to slot in rear of shell body.

9. Press trigger button to launch torpedos (right and left sides).

6. Press tail fin stabilizer into slots in the rear upper body.

7. Snap in rotating periscope into hole in the top of the shell body.

8. Lift up canopy and fit figure into position with hands on control levers.

Ages 4 and up

**Playmates®**

ASST. NO. 154150

STOCK NO. 54153

Do not use projectile other than those provided by the toy.

Teenage Mutant Ninja Turtles® © 2003 Mirage Studios, Inc. Teenage Mutant Ninja Turtles®, Leonardo®, Michelangelo®, Raphael®, Donatello®, Splinter®, Shredder®, and April O'Neil® are registered trademarks of Mirage Studios, Inc. All Rights Reserved. PRINTED IN CHINA.